

Statement of Information
**Single residential property located outside the
Melbourne metropolitan area**

Section 47AF of the Estate Agents Act 1980

Property offered for sale

Address
Including suburb or
locality and postcode

1170 Dairy Flat Road, Heathcote South Vic 3523

Indicative selling price

For the meaning of this price see consumer.vic.gov.au/underquoting

Range between

\$1,950,000

&

\$2,145,000

Median sale price*

Median price

Property Type

Suburb

Period - From

to

Source

Comparable property sales (*Delete A or B below as applicable)

~~A* These are the three properties sold within five kilometres of the property for sale in the last eighteen months that the estate agent or agent's representative considers to be most comparable to the property for sale.~~

Address of comparable property	Price	Date of sale
1		
2		
3		

OR

B* The estate agent or agent's representative reasonably believes that fewer than three comparable properties were sold within five kilometres of the property for sale in the last eighteen months.

This Statement of Information was prepared on:

18/02/2022 07:26

* When this Statement of Information was prepared, publicly available information providing median sale prices of residential property in the suburb or locality in which the property offered for sale is situated, and our sales records (if any), did not provide a median sale price that met the requirements of section 47AF (2)(b) of the Estate Agents Act 1980.

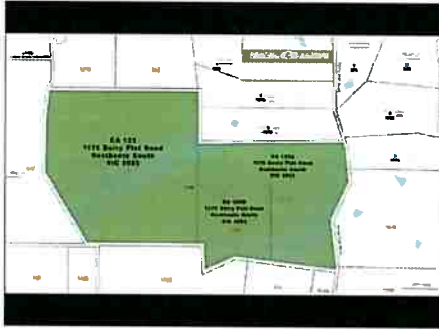

Property Type: Hobby Farm < 20 ha
Land Size: 133988 sqm approx
Agent Comments

Indicative Selling Price
\$1,950,000 - \$2,145,000
No median price available

Comparable Properties

The estate agent or agent's representative reasonably believes that fewer than three comparable properties were sold within five kilometres of the property for sale in the last eighteen months.